

## E4DL

LED Commercial Downlight  
Selectable CCT & Wattage  
4", 6", 8", & 10" options • 10-yr Warranty



## OVERVIEW

Energetic Lighting's E4DL series is suitable for use in a broad range of commercial applications. Available in 4 profile sizes from 4", 6", 8", up to 10", covering almost any application project. Utilizing today's latest innovative LED solutions and technologies paired with world class manufacturing practices, the E4DL provides customers an affordable LED downlight offering with the perfect blend of design, performance, value and reliability.

An extremely versatile product thanks to its stand-alone design without the need for a traditional recessed can housing. A flexible metal conduit pigtail with 1/2" trade-size adapter is included for power connection. With our integral EZCCT field-selectable CCT along with EZWATT field-selectable wattage (6", 8", 10" only), these panels extend use to a broad range of commercial and industrial applications, at the same time reducing the need for stocking CCT and wattage variable units.

The E4DL series is a great choice for renovation opportunities replacing existing commercial downlight fixtures or for new construction projects that require code compliant energy saving LED solutions. Ideally suited for office spaces, schools, retail, hospitality and healthcare applications, the E4DL provides high quality illumination with optimal energy savings.

## KEY FEATURES

- EZCCT field-selectable CCT for all models with - 3000K, 3500K & 4000K @ >90 CRI
- EZWATT field-selectable Wattage - 3 steps (6", 8", and 10" profiles), varied by models (see stock ordering information)
- 4", 6", 8", and 10" profiles available for design flexibility
- Suitable for Type-IC on models: 4", 6", & 8"; note: 10" profile model is Type Non-IC only
- External spring arms install to mounting surface without the need for a traditional recessed can
- Integrated flexible metal conduit pigtail lead with snap-in 1/2" trade-size knockout adapter, 24" total length provided for flexible installation options
- Strong and reliable spring loaded capture mounting arms ensure flush installation as well as safety (mechanical safety cable also provided as precautionary in case of mounting surface failure)
- Minimum 81% lumen maintenance @ 50,000 hours - L81/50,000 (per IES TM21)
- Minimum projected L70 @ 86,000 hours = maintenance free illumination (per IES TM21)

## Highlights



Field-selectable CCT and wattage control provides flexibility to installation and stocking



Universal spring clip arms allows direct mounting to surface without need for recessed can housing

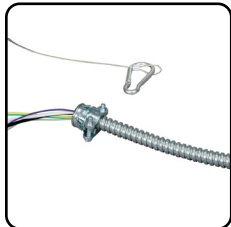

Flexible metal conduit lead with 1/2" trade-size knockout adapter; safety cable also provided



Stepped baffle trim for optical diffusion and modern aesthetic design

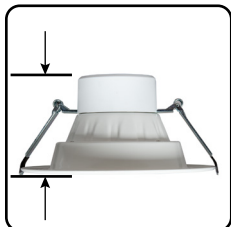

Without the need for a recessed can housing, the plenum height needs only accommodate the downlight body height

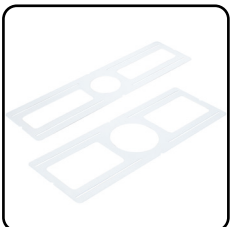

Optional Rough-in plates available in 4", 6", 8", or 9" downlight diameters (see next page for more details)

## Load Information

|                       |               |         |
|-----------------------|---------------|---------|
| <b>Input Voltage</b>  | 120-347Vac    |         |
| <b>Power Factor</b>   | 0.98          |         |
| <b>THD</b>            | 11%           |         |
| <b>Low Temp Start</b> | -25°C (-13°F) |         |
| <b>Max Temp</b>       | 45°C (113°F)  |         |
| <b>Unit Weight</b>    | 4" profile    | 1.0 LBS |
|                       | 6" profile    | 1.4 LBS |
|                       | 8" profile    | 2.0 LBS |
|                       | 10" profile   | 2.2 LBS |

## Dimensions

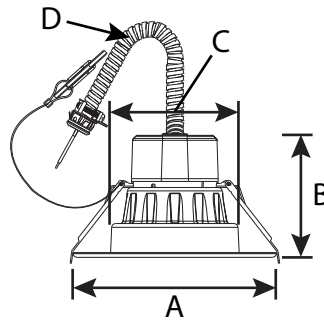

| Description                                     | Dim | Model profile |            |            |             |
|---|-----|---------------|------------|------------|-------------|
|   |     | 4" profile    | 6" profile | 8" profile | 10" profile |
| Front diameter (thru-hole upper limit diameter) | A   | 5.8"          | 8.3"       | 10.2"      | 11.2"       |
| Overall Height                                  | B   | 3.7"          | 4.0"       | 4.3"       | 4.6"        |
| Min thru-hole diameter                          | C   | 3.6"          | 5.8"       | 7.2"       | 8.2"        |
| Conduit overall length                          | D   | 24"           | 24"        | 24"        | 24"         |

## Shipping Information

| Item        | Weight | Box Qty. |
|-------------|--------|----------|
| 4" profile  | 7 lbs  | 6 per    |
| 6" profile  | 10 lbs | 6 per    |
| 8" profile  | 13 lbs | 6 per    |
| 10" profile | 16 lbs | 6 per    |

## Lumen Maintenance

| Profile | TM-21 Lumen Maint. (50,000 hours) | Theoretical L70 (hours) |
|---------|-----------------------------------|-------------------------|
| 4"      | >83%                              | 94,000                  |
| 6"      | >89%                              | 162,000                 |
| 8"      | >83%                              | 93,000                  |
| 10"     | >81%                              | 86,000                  |

Ambient Temperature: 25°C

## Specific Lumen Output

| Profile | Wattage Setting | Color Temperature Setting |       |       |
|---------|-----------------|---------------------------|-------|-------|
|         |                 | 3000K                     | 3500K | 4000K |
| 4"      | 12W             | 920                       | 998   | 955   |
|         | 10W             | 800                       | 832   | 800   |
| 6"      | 12W             | 1000                      | 1040  | 1001  |
|         | 17W             | 1400                      | 1456  | 1402  |
| 8"      | 14W             | 1200                      | 1296  | 1243  |
|         | 17W             | 1450                      | 1566  | 1502  |
|         | 20W             | 1750                      | 1890  | 1813  |
| 10"     | 30W             | 2300                      | 2446  | 2368  |
|         | 35W             | 2700                      | 2872  | 2751  |
|         | 40W             | 3150                      | 3351  | 3245  |

**STOCK ORDERING INFORMATION**

**4" Profile**

| Catalog Logic   | Order # | Lumens | Wattage | LPW  | Color Temp                     | CRI | Voltage | Dimming | Energy Star | Pallet Qty |
|-----------------|---------|--------|---------|------|--------------------------------|-----|---------|---------|-------------|------------|
| E4DLH12D4-93040 | 50037   | 920 LM | 12      | 78.5 | 3000K, 3500K, 4000K selectable | 93  | 120-347 | 0-10v   | Energy Star | TBA        |

**6" Profile**

| Catalog Logic     | Order # | Lumens                          | Wattage                  | LPW | Color Temp                     | CRI | Voltage | Dimming | Energy Star | Pallet Qty |
|-------------------|---------|---------------------------------|--------------------------|-----|--------------------------------|-----|---------|---------|-------------|------------|
| E4DLH1017D6-93040 | 50038   | 800, 1000, 1400 (LM) Selectable | 10W, 12W, 17W selectable | 85  | 3000K, 3500K, 4000K selectable | 93  | 120-347 | 0-10v   | Energy Star | 300        |

**8" Profile**

| Catalog Logic     | Order # | Lumens                           | Wattage                  | LPW  | Color Temp                     | CRI | Voltage | Dimming | Energy Star | Pallet Qty |
|-------------------|---------|----------------------------------|--------------------------|------|--------------------------------|-----|---------|---------|-------------|------------|
| E4DLH1420D8-93040 | 50039   | 1200, 1450, 1750 (LM) Selectable | 14W, 17W, 20W selectable | 88.5 | 3000K, 3500K, 4000K selectable | 93  | 120-347 | 0-10v   | Energy Star | 180        |

**10" Profile**

| Catalog Logic      | Order # | Lumens                           | Wattage                  | LPW  | Color Temp                     | CRI | Voltage | Dimming | Energy Star | Pallet Qty |
|--------------------|---------|----------------------------------|--------------------------|------|--------------------------------|-----|---------|---------|-------------|------------|
| E4DLH3040D10-93040 | 50040   | 2300, 2700, 3150 (LM) Selectable | 30W, 35W, 40W selectable | 79.5 | 3000K, 3500K, 4000K selectable | 93  | 120-347 | 0-10v   | Energy Star | 180        |

**Optional Accessories**

**E1RIP-4**

Rough-in plate for 4" downlights

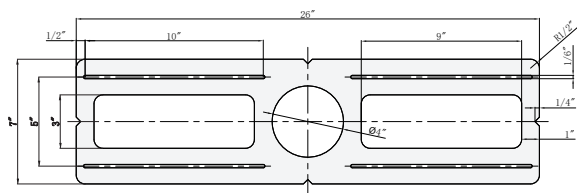

**E1RIP-8**

Rough-in plate for 8" downlights

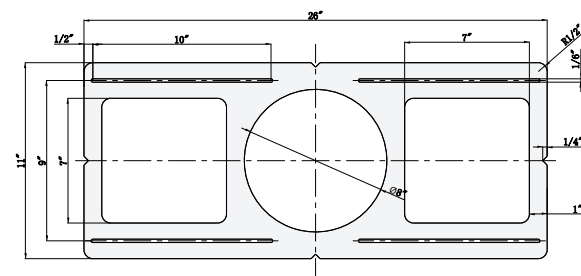

**E1RIP-6**

Rough-in plate for 6" downlights

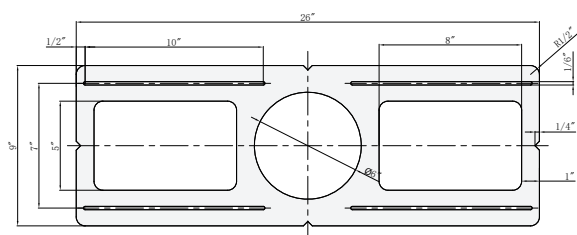

**E1RIP-10**

Rough-in plate for 10" downlights

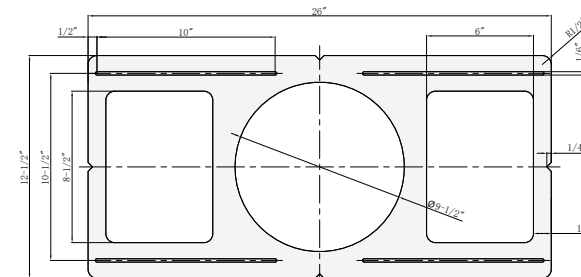

**PHOTOMETRIC DATA**

Cat Logic: E4DLH12D4-93040 \*  
 Test Report: E4DLH12D4-93040\_(3000K).IES  
 CCT: set at 3000K for test  
 Lamp Type: LED  
 Lumens: 920 LM  
 Input Watts: 11.98 W  
 Efficacy: 77 LM/W  
 Spacing Criteria: [0° : 1.18] [90° : 1.18]

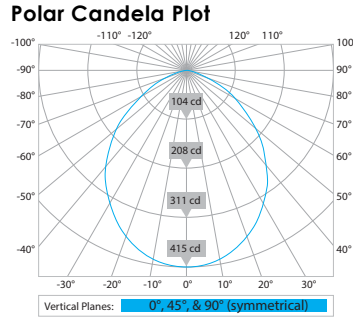

**Zonal Lumen Summary**

| Zone  | Lumens | %Luminaire |
|-------|--------|------------|
| 0-20  | 149.02 | 16.2       |
| 0-30  | 309.79 | 33.7       |
| 0-40  | 494.19 | 53.7       |
| 0-60  | 805.05 | 87.5       |
| 0-80  | 914.69 | 99.4       |
| 0-90  | 920.12 | 100        |
| 0-180 | 920.12 | 100        |

**Coefficients of Utilization**

Effective Floor Cavity Reflectance 0.20

| rc  | 80% |     |     |     | 70% |     |     |     | 50% |     |     | 30% |     |     | 10% |     |     | 0%  |   |
|-----|-----|-----|-----|-----|-----|-----|-----|-----|-----|-----|-----|-----|-----|-----|-----|-----|-----|-----|---|
|     | rw  | 70  | 50  | 30  | 10  | 70  | 50  | 30  | 10  | 50  | 30  | 10  | 50  | 30  | 10  | 50  | 30  | 10  | 0 |
| RCR |     |     |     |     |     |     |     |     |     |     |     |     |     |     |     |     |     |     |   |
| 0   | 119 | 119 | 119 | 119 | 116 | 116 | 116 | 116 | 111 | 111 | 111 | 106 | 106 | 106 | 102 | 102 | 102 | 100 |   |
| 1   | 110 | 106 | 103 | 99  | 108 | 104 | 101 | 98  | 100 | 97  | 95  | 96  | 94  | 92  | 92  | 91  | 89  | 87  |   |
| 2   | 102 | 94  | 88  | 83  | 99  | 92  | 87  | 82  | 89  | 84  | 80  | 86  | 82  | 79  | 83  | 80  | 77  | 75  |   |
| 3   | 93  | 84  | 77  | 71  | 91  | 82  | 76  | 70  | 79  | 74  | 69  | 77  | 72  | 68  | 74  | 70  | 67  | 65  |   |
| 4   | 86  | 75  | 67  | 61  | 84  | 74  | 66  | 61  | 71  | 65  | 60  | 69  | 63  | 59  | 67  | 62  | 58  | 56  |   |
| 5   | 80  | 68  | 59  | 53  | 77  | 67  | 59  | 53  | 64  | 58  | 52  | 63  | 57  | 52  | 61  | 55  | 51  | 49  |   |
| 6   | 74  | 61  | 53  | 47  | 72  | 60  | 52  | 47  | 59  | 52  | 46  | 57  | 51  | 46  | 55  | 50  | 46  | 44  |   |
| 7   | 69  | 56  | 48  | 42  | 67  | 55  | 47  | 42  | 54  | 46  | 41  | 52  | 46  | 41  | 51  | 45  | 41  | 39  |   |
| 8   | 64  | 51  | 43  | 38  | 62  | 50  | 43  | 37  | 49  | 42  | 37  | 48  | 42  | 37  | 47  | 41  | 37  | 35  |   |
| 9   | 60  | 47  | 39  | 34  | 58  | 47  | 39  | 34  | 45  | 39  | 34  | 44  | 38  | 34  | 43  | 38  | 33  | 32  |   |
| 10  | 56  | 44  | 36  | 31  | 55  | 43  | 36  | 31  | 42  | 35  | 31  | 41  | 35  | 31  | 40  | 35  | 31  | 29  |   |

\* NOTE: Data produced from 3000K CCT setting where:  
 - 3500K values can be estimated by increasing of 1.085 factor from 3000K  
 - 4000K values can be estimated by increasing by a factor of 1.038 from 3000K

**Isofootcandle Sampling**

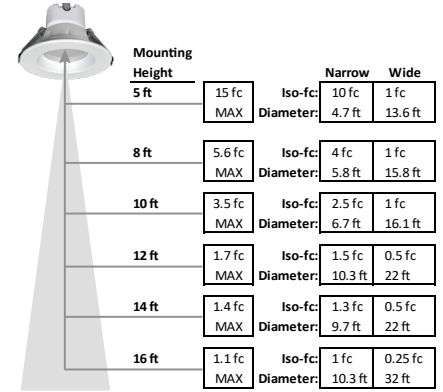

**PHOTOMETRIC DATA**

Cat Logic: E4DLH1017D6-93040 \*  
 Test Report: E4DLH1017D6-93040\_(3000K).IES  
 CCT: set at 3000K & 17W for test  
 Lamp Type: LED  
 Lumens: 1400 LM  
 Input Watts: 16.25 W  
 Efficacy: 90 LM/W  
 Spacing Criteria: [0° : 1.24] [90° : 1.24]

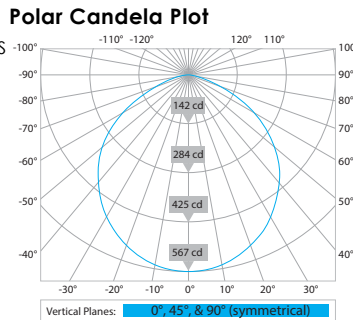

**Zonal Lumen Summary**

| Zone  | Lumens  | %Luminaire |
|-------|---------|------------|
| 0-20  | 206.32  | 14.2       |
| 0-30  | 436.19  | 30         |
| 0-40  | 711.39  | 48.9       |
| 0-60  | 1239.96 | 85.2       |
| 0-80  | 1448.9  | 99.5       |
| 0-90  | 1456.15 | 100        |
| 0-180 | 1456.15 | 100        |

**Coefficients of Utilization**

Effective Floor Cavity Reflectance 0.20

| rc  | 80% |     |     |     | 70% |     |     |     | 50% |     |     | 30% |     |     | 10% |     |     | 0%  |   |
|-----|-----|-----|-----|-----|-----|-----|-----|-----|-----|-----|-----|-----|-----|-----|-----|-----|-----|-----|---|
|     | rw  | 70  | 50  | 30  | 10  | 70  | 50  | 30  | 10  | 50  | 30  | 10  | 50  | 30  | 10  | 50  | 30  | 10  | 0 |
| RCR |     |     |     |     |     |     |     |     |     |     |     |     |     |     |     |     |     |     |   |
| 0   | 119 | 119 | 119 | 119 | 116 | 116 | 116 | 116 | 111 | 111 | 111 | 106 | 106 | 106 | 102 | 102 | 102 | 100 |   |
| 1   | 110 | 106 | 102 | 99  | 107 | 104 | 100 | 97  | 99  | 96  | 94  | 95  | 93  | 91  | 92  | 90  | 88  | 86  |   |
| 2   | 101 | 93  | 87  | 82  | 98  | 91  | 85  | 81  | 88  | 83  | 79  | 85  | 81  | 77  | 82  | 78  | 75  | 73  |   |
| 3   | 92  | 82  | 75  | 69  | 90  | 81  | 74  | 68  | 78  | 72  | 67  | 75  | 70  | 66  | 73  | 68  | 64  | 62  |   |
| 4   | 85  | 73  | 65  | 58  | 82  | 72  | 64  | 58  | 69  | 63  | 57  | 67  | 61  | 56  | 65  | 60  | 56  | 54  |   |
| 5   | 78  | 66  | 57  | 51  | 76  | 64  | 56  | 50  | 62  | 55  | 50  | 60  | 54  | 49  | 59  | 53  | 49  | 47  |   |
| 6   | 72  | 59  | 50  | 44  | 70  | 58  | 50  | 44  | 56  | 49  | 44  | 55  | 48  | 43  | 53  | 47  | 43  | 41  |   |
| 7   | 67  | 54  | 45  | 39  | 65  | 53  | 45  | 39  | 51  | 44  | 39  | 50  | 43  | 38  | 49  | 43  | 38  | 36  |   |
| 8   | 62  | 49  | 41  | 35  | 61  | 48  | 40  | 35  | 47  | 40  | 35  | 46  | 39  | 34  | 45  | 39  | 34  | 32  |   |
| 9   | 58  | 45  | 37  | 31  | 57  | 44  | 37  | 31  | 43  | 36  | 31  | 42  | 36  | 31  | 41  | 35  | 31  | 29  |   |
| 10  | 54  | 41  | 34  | 29  | 53  | 41  | 33  | 28  | 40  | 33  | 28  | 39  | 33  | 28  | 38  | 32  | 28  | 26  |   |

\* NOTE: Data produced from 3000K CCT setting where:  
 - 3500K values can be estimated by increasing of 1.040 factor from 3000K  
 - 4000K values can be estimated by increasing by a factor of 1.000 from 3000K  
 Data produced from highest wattage setting where lower wattage data values may be estimated by an equivalent proportional reduction as the wattage reduction factor (example: 17W to 12W use: 0.706 reduction factor)

**Isofootcandle Sampling**

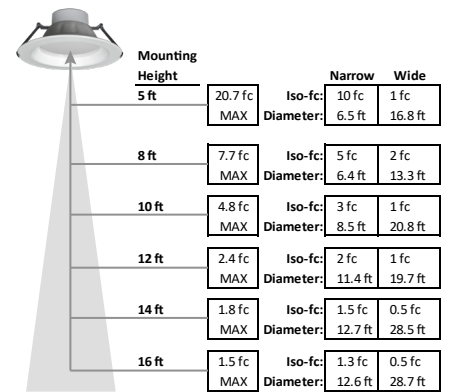

**PHOTOMETRIC DATA**

Cat Logic: E4DLH1420D8-93040 \*  
 Test Report: E4DLH1420D8-93040\_(3000K).IES  
 CCT: set at 3000K & 20W for test  
 Lamp Type: LED  
 Lumens: 1750 LM  
 Input Watts: 19.96 W  
 Efficacy: 88 LM/W  
 Spacing Criteria: [0° : 1.22] [90° : 1.22]

**Polar Candela Plot**

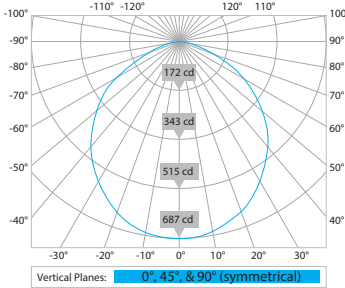

**Zonal Lumen Summary**

| Zone  | Lumens  | %Luminaire |
|-------|---------|------------|
| 0-20  | 249.06  | 14.2       |
| 0-30  | 524.48  | 30         |
| 0-40  | 850.43  | 48.6       |
| 0-60  | 1469.65 | 84         |
| 0-80  | 1741.14 | 99.5       |
| 0-90  | 1750.21 | 100        |
| 0-180 | 1750.22 | 100        |

**Coefficients of Utilization**

Effective Floor Cavity Reflectance 0.20

| rc  | 80% |     |     |     | 70% |     |     |     | 50% |     |     | 30% |     |     | 10% |     |     | 0% |     |  |
|-----|-----|-----|-----|-----|-----|-----|-----|-----|-----|-----|-----|-----|-----|-----|-----|-----|-----|----|-----|--|
|     | rw  | 70  | 50  | 30  | 10  | 70  | 50  | 30  | 10  | 50  | 30  | 10  | 50  | 30  | 10  | 50  | 30  | 10 | 0   |  |
| RCR |     |     |     |     |     |     |     |     |     |     |     |     |     |     |     |     |     |    |     |  |
| 0   | 119 | 119 | 119 | 119 | 116 | 116 | 116 | 116 | 111 | 111 | 111 | 106 | 106 | 106 | 102 | 102 | 102 |    | 100 |  |
| 1   | 110 | 106 | 102 | 98  | 107 | 103 | 100 | 97  | 99  | 96  | 94  | 95  | 93  | 91  | 92  | 90  | 88  |    | 86  |  |
| 2   | 100 | 93  | 86  | 81  | 98  | 91  | 85  | 80  | 87  | 82  | 78  | 84  | 80  | 76  | 81  | 78  | 75  |    | 73  |  |
| 3   | 92  | 82  | 74  | 68  | 89  | 80  | 73  | 67  | 77  | 71  | 66  | 75  | 69  | 65  | 72  | 68  | 64  |    | 62  |  |
| 4   | 84  | 73  | 64  | 58  | 82  | 71  | 64  | 58  | 69  | 62  | 57  | 67  | 61  | 56  | 65  | 59  | 55  |    | 53  |  |
| 5   | 78  | 65  | 57  | 50  | 76  | 64  | 56  | 50  | 62  | 55  | 49  | 60  | 54  | 49  | 58  | 53  | 48  |    | 46  |  |
| 6   | 72  | 59  | 50  | 44  | 70  | 58  | 50  | 44  | 56  | 49  | 43  | 54  | 48  | 43  | 53  | 47  | 43  |    | 41  |  |
| 7   | 67  | 53  | 45  | 39  | 65  | 53  | 44  | 39  | 51  | 44  | 38  | 50  | 43  | 38  | 48  | 42  | 38  |    | 36  |  |
| 8   | 62  | 49  | 40  | 35  | 60  | 48  | 40  | 35  | 47  | 40  | 34  | 46  | 39  | 34  | 44  | 38  | 34  |    | 32  |  |
| 9   | 58  | 45  | 37  | 31  | 57  | 44  | 36  | 31  | 43  | 36  | 31  | 42  | 36  | 31  | 41  | 35  | 31  |    | 29  |  |
| 10  | 54  | 41  | 34  | 28  | 53  | 41  | 33  | 28  | 40  | 33  | 28  | 39  | 33  | 28  | 38  | 32  | 28  |    | 26  |  |

\* NOTE: Data produced from 3000K CCT setting where:  
 -3500K values can be estimated by increasing of 1.080 factor from 3000K  
 -4000K values can be estimated by increasing by a factor of 1.036 from 3000K  
 Data produced from highest wattage setting where lower wattage data values may be estimated by an equivalent proportional reduction as the wattage reduction factor (example: 20W to 17W use 0.85 reduction factor)

**Isofootcandle Sampling**

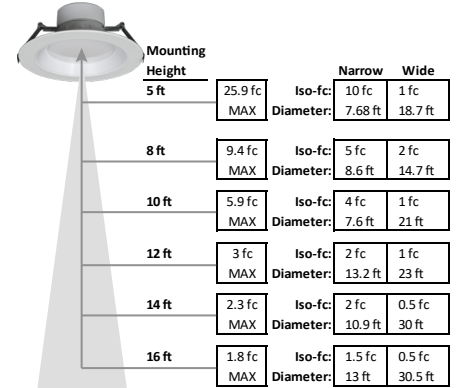

**PHOTOMETRIC DATA**

Cat Logic: E4DLH3040D10-93040 \*  
 Test Report: E4DLH3040D10-93040\_(3000K).IES  
 CCT: set at 3000K & 40W for test  
 Lamp Type: LED  
 Lumens: 3150 LM  
 Input Watts: 39.92 W  
 Efficacy: 79 LM/W  
 Spacing Criteria: [0° : 1.22] [90° : 1.22]

**Polar Candela Plot**

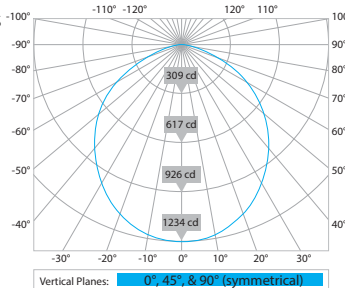

**Zonal Lumen Summary**

| Zone  | Lumens  | %Luminaire |
|-------|---------|------------|
| 0-20  | 446.88  | 14.2       |
| 0-30  | 938.73  | 29.8       |
| 0-40  | 1517.7  | 48.2       |
| 0-60  | 2619.07 | 83.1       |
| 0-80  | 3132.63 | 99.4       |
| 0-90  | 3150.32 | 100        |
| 0-180 | 3150.37 | 100        |

**Coefficients of Utilization**

Effective Floor Cavity Reflectance 0.20

| rc  | 80% |     |     |     | 70% |     |     |     | 50% |     |     | 30% |     |     | 10% |     |     | 0% |     |  |
|-----|-----|-----|-----|-----|-----|-----|-----|-----|-----|-----|-----|-----|-----|-----|-----|-----|-----|----|-----|--|
|     | rw  | 70  | 50  | 30  | 10  | 70  | 50  | 30  | 10  | 50  | 30  | 10  | 50  | 30  | 10  | 50  | 30  | 10 | 0   |  |
| RCR |     |     |     |     |     |     |     |     |     |     |     |     |     |     |     |     |     |    |     |  |
| 0   | 119 | 119 | 119 | 119 | 116 | 116 | 116 | 116 | 111 | 111 | 111 | 106 | 106 | 106 | 102 | 102 | 102 |    | 100 |  |
| 1   | 110 | 105 | 101 | 98  | 107 | 103 | 100 | 96  | 99  | 96  | 93  | 95  | 93  | 90  | 91  | 90  | 88  |    | 86  |  |
| 2   | 100 | 92  | 86  | 81  | 98  | 91  | 85  | 80  | 87  | 82  | 78  | 84  | 80  | 76  | 81  | 77  | 74  |    | 72  |  |
| 3   | 92  | 82  | 74  | 68  | 89  | 80  | 73  | 67  | 77  | 71  | 66  | 74  | 69  | 65  | 72  | 67  | 64  |    | 61  |  |
| 4   | 84  | 72  | 64  | 58  | 82  | 71  | 63  | 57  | 69  | 62  | 56  | 66  | 60  | 56  | 64  | 59  | 55  |    | 53  |  |
| 5   | 77  | 65  | 56  | 50  | 75  | 64  | 56  | 49  | 62  | 54  | 49  | 60  | 53  | 48  | 58  | 52  | 48  |    | 46  |  |
| 6   | 72  | 59  | 50  | 44  | 70  | 58  | 49  | 43  | 56  | 48  | 43  | 54  | 48  | 43  | 53  | 47  | 42  |    | 40  |  |
| 7   | 66  | 53  | 45  | 39  | 65  | 52  | 44  | 38  | 51  | 43  | 38  | 49  | 43  | 38  | 48  | 42  | 38  |    | 36  |  |
| 8   | 62  | 49  | 40  | 34  | 60  | 48  | 40  | 34  | 47  | 39  | 34  | 45  | 39  | 34  | 44  | 38  | 34  |    | 32  |  |
| 9   | 58  | 45  | 37  | 31  | 56  | 44  | 36  | 31  | 43  | 36  | 31  | 42  | 35  | 31  | 41  | 35  | 30  |    | 29  |  |
| 10  | 54  | 41  | 33  | 28  | 53  | 41  | 33  | 28  | 40  | 33  | 28  | 39  | 32  | 28  | 38  | 32  | 28  |    | 26  |  |

\* NOTE: Data produced from 3000K CCT setting where:  
 -3500K values can be estimated by increasing of 1.063 factor from 3000K  
 -4000K values can be estimated by increasing by a factor of 1.030 from 3000K  
 Data produced from highest wattage setting where lower wattage data values may be estimated by an equivalent proportional reduction as the wattage reduction factor (example: 40W to 35W use 0.875 reduction factor)

**Isofootcandle Sampling**

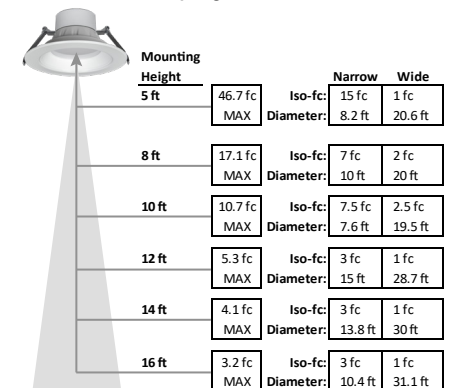



**ENERGETIC**  
L I G H T I N G

**E4DL**

CCT&W-Select LED Commercial Downlight  
50,000 System Lifetime • 10-yr Warranty

**NOTES:**

A large, empty rectangular box with a blue border, intended for user notes or specifications.



**ENERGETIC**  
L I G H T I N G

**E4DL**

CCT&W-Select LED Commercial Downlight  
50,000 System Lifetime • 10-yr Warranty

**NOTES:**

A large, empty rectangular box with a blue border, intended for user notes or specifications.